

ASSEMBLY INSTRUCTIONS – NO. 1466 OIL BOTTLE CADDY

CAUTION: To avoid loss of parts, do not discard shipping container until assembly is complete.

EXAMINE ILLUSTRATION AND READ COMPLETELY THROUGH THESE INSTRUCTIONS BEFORE BEGINNING ASSEMBLY

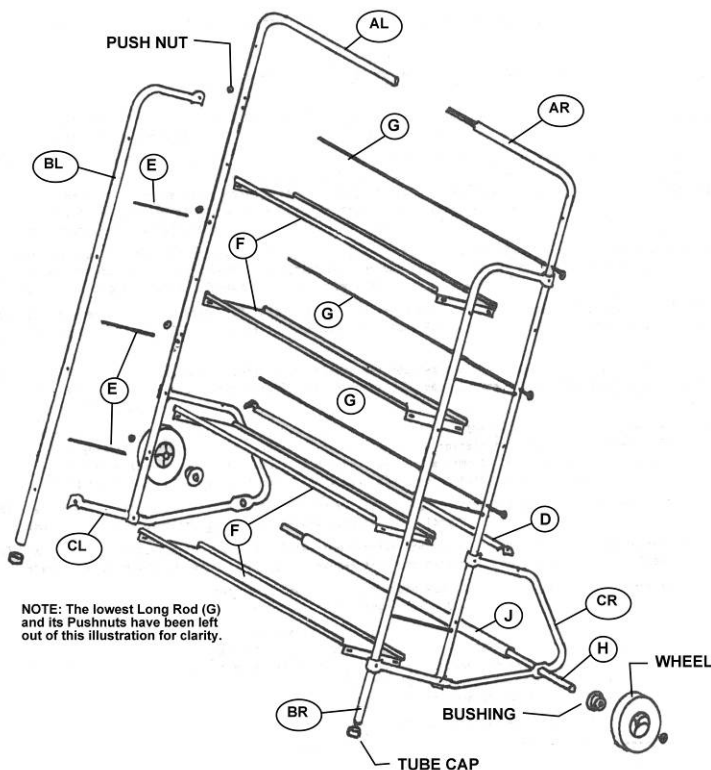

- (1) Separate and group together parts AL, BL, & CL; and parts AR, BR, & CR. Note that there is a left-hand group and a right-hand group. Refer to the illustration to determine which pieces are Left and which are Right.
- (2) Assemble the Left Strut, CL, to the Left Rear Leg, AL, using two of the longer screws, and inserting the screws from the outside of the unit. Leave nuts slightly loose.
- (3) Push a plastic Tube Cap onto the bottom end of the Left Front Leg, BL. Put one Short Rod, E, in the lowest rod hole of the Left Front Leg, BL, and then the lowest rod hole of the Left Rear Leg, AL. (Note that the holes for the Short Rods go through only one wall of each Leg.) Now assemble the joint between the Front Leg and the Strut, using another of the longer screws, inserted from the outside of the unit. Leave the nut slightly loose.

- (4) In the assembly from above - Step (3) - insert Short Rods into the middle and then the top Short Rod holes in both Legs, then assemble the joint between the Legs using one of the shorter screws. Leave all nuts slightly loose. Temporarily set aside this Left Side Assembly.
- (5) In a manner similar to Steps (2), (3), &(4) above, make a Right Side Assembly from the right Strut CR, the Right Rear Leg, AR, a plastic Tube Cap, the Right Front Leg, BR, and the three remaining Short Rods.
- (6) Stand the two side assemblies upright and insert the reduced end of the Right Rear Leg into the Left Rear Leg, as illustrated. Then install Rear Spreader, D, between the two Struts, leaving the nuts slightly loose.
- (7) Fasten the next-to-the-bottom Shelf, F, into position. Note that the nuts on the long screws which were used to assemble the rear joints will have to be removed to install this shelf, and then replaced (if the longer screws were not already used here, now is the time to correct that error.) Make sure the long shelf lips point up when making this assembly. Leave nuts slightly loose.

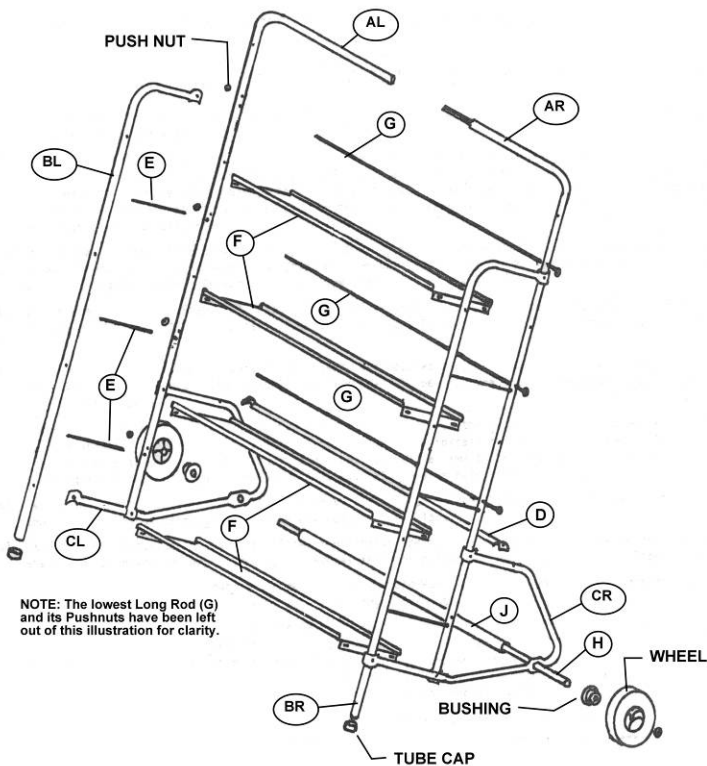

- (8) Fasten the bottom Shelf in place, being sure that the longer screws are used. Make sure that the long shelf lips point up, and leave all nuts slightly loose.
- (9) Fasten the bottom Shelf in place, and finally the top Shelf, being sure to keep the long shelf lips pointing up, and inserting the screws from the outside. Leave all fasteners slightly loose.
- (10) Tap one of the smaller Pushnuts onto one end of each Long Rod, G. Now insert The Long Rods through both Rear Legs and secure each one by firmly tapping a Pushnut on the end.

- (11) Tap a large Pushnut onto one end of the Axle, H, then slip the Axle through one Wheel from the recessed face. Next slip a Bushing onto the Axle, big end away from the wheel, then push the axle through the axle hole in one Strut and into the Axle Cover, J. Finally, push the Axle through the axle hole in the other Strut, slip on the other Bushing, with the big end toward the Strut, push on a Wheel—recessed face out. Finally tap the other Pushnut firmly onto the end of the Axle.
- (12) Stand the assembled unit upright on a flat, level surface and tighten all fasteners.

In case of parts shortage or defects, describe missing or defective part by name and letter as used in these instructions, and report to the manufacturer:

WARREN STEEL SPECIALTIES CORPORATION
 P.O. Box 1391 Warren, OH 44482
 (330) 399-8360